

Main applications :

High frequency electronic balasts,

Resonant circuits, induction heaters

High-end audio applications



**GENERAL TECHNICAL CHARACTERISTICS**

- Dielectric : Polypropylene film
- Construction : Extended metallized film
- Case : Polyester tape wrapping; UL94V-0 resin end fill
- Leads: Tinned copper wire

**ELECTRICAL CHARACTERISTICS**

- Working temperature : - 40 to + 85 °C
- Capacitance : 0.15 to 60µF
- Rated Voltage : 250 to 850 Vdc
- Tolerance : ± 5%, ± 10%
- Dissipation factor: Measured at 1000±20 Hz and 25±5°C.  
When Cr≤5.0µF, 6×10<sup>-4</sup>;  
When Cr>5.0µF, 10×10<sup>-4</sup> -- 15×10<sup>-4</sup>

**TEST METHODS AND PERFORMANCES**

- Dielectric strength: 2Ur (DC) applied for 10s at 25±5°C  
(1 minute for type test)
- Insulation resistance : 3000s but need not exceed 30GΩ  
(typical value), after 1 minute of electrification at 100Vdc (25±5°C)

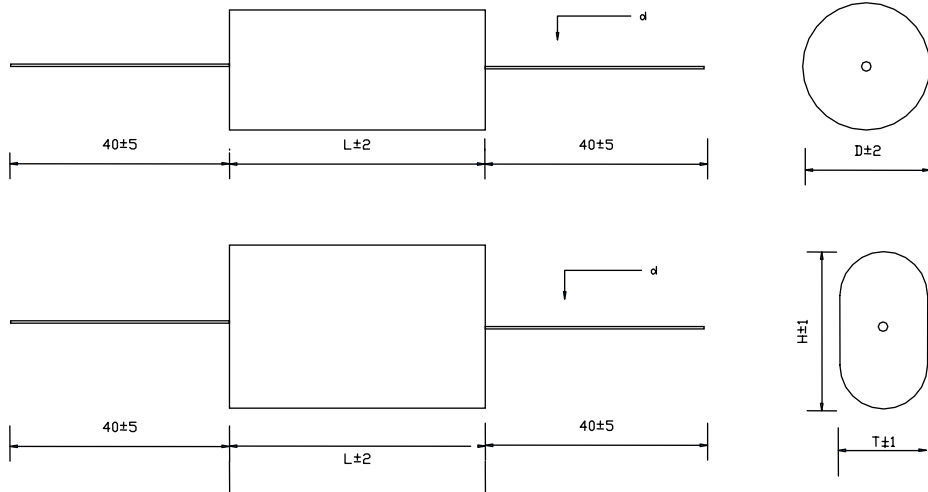

How to Order:

STH- 600 -4.7- 44 FO

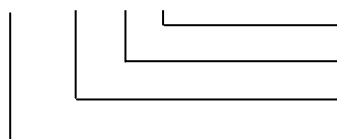

- FO for flat,oval
- Length
- Capacitance
- Voltage

Electrical specifications, ordering codes

Part Number	Cap (µF)	Dimension (mm)					du/dt (v/µs)	Ipeak (A)	Irms max.(A)	ESR (mΩ)
		flat,oval								
		L	D	T	H	d				
<b>Ur 250Vdc, Upk 400Vdc, Urms 160Vac</b>										
STH-250-2.0	2.0	32	11.8	7.7	14.1	0.8	40	80	5	17.2
STH-250-2.2	2.2	32	12.3	8.1	14.5	0.8	40	88	6	15.7
STH-250-2.5	2.5	32	12.9	8.8	15.2	0.8	40	100	7	13.9
STH-250-3.0	3.0	32	14.0	9.8	16.2	0.8	40	120	7	11.7
STH-250-3.3	3.3	32	14.5	10.4	16.8	0.8	40	132	7	10.7
STH-250-4.0	4.0	32	15.8	11.0	19.0	1.0	40	160	9	8.9
STH-250-4.7	4.7	32	17.0	12.1	20.1	1.0	40	188	9	7.7
STH-250-5.0	5.0	32	17.5	12.6	20.6	1.0	40	200	9	7.3
STH-250-6.8	6.8	32	20.1	15.2	23.2	1.0	40	272	9	5.5
STH-250-10	10	32	24.0	19.0	27.0	1.0	40	400	9	3.9
STH-250-10	10	44	19.9	15.0	23.0	1.0	25	250	9	6.9
STH-250-15	15	44	24.0	19.0	27.0	1.2	25	375	12	4.8
STH-250-20	20	44	27.5	20.9	32.1	1.2	25	500	12	3.7
STH-250-22	22	44	28.7	22.2	33.4	1.2	25	550	12	3.4
STH-250-25	25	44	30.5	24.0	35.2	1.2	25	625	12	3.1
STH-250-30	30	44	33.3	26.7	37.9	1.2	25	750	12	2.7
STH-250-30	30	57	27.5	20.9	32.1	1.2	15	450	12	4.8
STH-250-33	33	57	28.7	22.2	33.4	1.2	15	495	12	4.4
STH-250-40	40	57	31.5	24.9	36.1	1.2	15	600	12	3.7
STH-250-50	50	57	35.1	28.4	39.6	1.2	15	750	12	3.1
STH-250-60	60	57	38.3	31.6	42.8	1.2	15	900	12	2.6
<b>Ur 330Vdc, Upk 500Vdc, Urms 200Vac</b>										
STH-330-1.5	1.5	32	12.6	8.5	14.9	0.8	45	68	6	18.2
STH-330-2.0	2.0	32	14.3	10.1	16.5	0.8	45	90	7	13.8
STH-330-2.2	2.2	32	14.8	10.7	17.1	0.8	45	99	7	12.7
STH-330-2.5	2.5	32	15.7	10.9	18.9	1.0	45	113	8	11.2
STH-330-3.0	3.0	32	17.0	12.1	20.1	1.0	45	135	9	9.5
STH-330-3.3	3.3	32	17.7	12.9	20.9	1.0	45	149	9	8.7
STH-330-4.0	4.0	32	19.4	14.5	22.5	1.0	45	180	9	7.3
STH-330-4.7	4.7	32	20.8	15.9	23.9	1.0	45	212	9	6.3
STH-330-4.7	4.7	44	17.3	12.5	20.5	1.0	30	141	9	11.4
STH-330-5.0	5.0	32	21.4	16.5	24.5	1.0	45	225	9	5.9
STH-330-5.0	5.0	44	17.8	12.9	20.9	1.0	30	150	9	10.7
STH-330-6.8	6.8	44	20.5	15.6	23.6	1.2	30	204	9	8.0
STH-330-10	10	44	24.5	19.6	27.6	1.2	30	300	12	5.7
STH-330-12	12	44	26.7	20.2	31.4	1.2	30	360	12	4.8
STH-330-15	15	44	29.7	23.1	34.3	1.2	30	450	12	4.0
STH-330-15	15	57	24.5	19.6	27.6	1.2	20	300	12	7.3
STH-330-20	20	57	28.1	21.5	32.7	1.2	20	400	12	5.6
STH-330-22	22	57	29.4	22.8	34.0	1.2	20	440	12	5.1
STH-330-25	25	57	31.2	24.6	35.8	1.2	20	500	12	4.6
STH-330-30	30	57	34.0	27.4	38.6	1.2	20	600	12	3.9
STH-330-33	33	57	35.6	29.0	40.2	1.2	20	660	12	3.6
STH-330-35	35	57	36.7	30.0	41.2	1.2	20	700	12	3.4
STH-330-40	40	57	39.1	32.4	43.6	1.2	20	800	12	3.1
<b>Ur 400Vdc, Upk 600Vdc, Urms 250Vac</b>										
STH-400-0.68	0.68	32	10.7	6.6	13.0	0.8	55	37	5.5	32.2
STH-400-1.0	1.0	32	12.5	8.3	14.7	0.8	55	55	6	22.4
STH-400-1.5	1.5	32	14.8	10.6	17.0	0.8	55	83	7	15.2
STH-400-2.0	2.0	32	16.8	11.9	19.9	1.0	55	110	9	11.6
STH-400-2.2	2.2	32	17.5	12.6	20.6	1.0	55	121	9	10.6
STH-400-2.5	2.5	32	18.5	13.6	21.6	1.0	55	138	9	9.4
STH-400-3.0	3.0	32	20.1	15.2	23.2	1.0	55	165	9	8.0
STH-400-3.3	3.3	32	21.0	16.1	24.1	1.0	55	182	9	7.3

### Electrical specifications, ordering codes

Part Number	Cap ( $\mu$ F)	Dimension (mm)					du/dt (v/ $\mu$ s)	Ipeak (A)	Irms max.(A)	ESR (m $\Omega$ )
		flat,oval								
		L	D	T	H	d				
<b>Ur 400Vdc, Upk 600Vdc, Urms 250Vac</b>										
STH-400-3.3	3.3	44	17.5	12.6	20.6	1.0	40	132	9	13.3
STH-400-4.0	4.0	32	22.9	18.0	26.0	1.0	55	220	9	6.1
STH-400-4.0	4.0	44	19.1	14.2	22.2	1.0	40	160	9	11.1
STH-400-4.7	4.7	44	20.5	15.6	23.6	1.0	40	188	9	9.5
STH-400-5.0	5.0	44	21.1	16.2	24.2	1.2	40	200	11	9.0
STH-400-6.8	6.8	44	24.3	19.4	27.4	1.2	40	272	11	6.8
STH-400-10	10	44	29.2	22.6	33.8	1.2	40	400	12	4.8
STH-400-10	10	57	24.1	19.1	27.1	1.2	25	250	11	8.9
STH-400-15	15	57	29.2	22.6	33.8	1.2	25	375	12	6.1
STH-400-20	20	57	33.4	26.8	38.0	1.2	25	500	12	4.7
STH-400-22	22	57	35.0	28.3	39.5	1.2	25	550	12	4.4
STH-400-25	25	57	37.2	30.5	41.7	1.2	25	625	12	3.9
<b>Ur 600Vdc, Upk 800Vdc, Urms 330Vac</b>										
STH-600-0.47	0.47	32	11.7	7.6	14.0	0.8	75	35	5	34.5
STH-600-0.68	0.68	32	13.6	9.4	15.8	0.8	75	51	6	24.3
STH-600-1.0	1.0	32	16.0	11.9	18.3	0.8	75	75	8	16.9
STH-600-1.5	1.5	32	19.2	15.0	21.4	1.0	75	113	9	11.6
STH-600-2.0	2.0	32	21.8	17.7	24.1	1.0	75	150	9	8.9
STH-600-2.0	2.0	44	17.0	13.0	18.9	1.0	55	110	9	16.2
STH-600-2.2	2.2	32	22.8	18.7	25.1	1.0	75	165	9	8.1
STH-600-2.2	2.2	44	17.7	13.7	19.6	1.0	55	121	9	14.8
STH-600-2.5	2.5	44	18.8	14.0	21.5	1.0	55	138	9	13.1
STH-600-3.0	3.0	44	20.4	15.6	23.1	1.0	55	165	9	11.0
STH-600-3.3	3.3	44	21.3	16.5	24.0	1.0	55	182	9	10.1
STH-600-4.0	4.0	44	23.3	18.5	26.0	1.0	55	220	12	9.6
STH-600-4.7	4.7	44	25.1	20.3	27.8	1.2	55	259	12	8.5
STH-600-4.7	4.7	57	22.3	17.3	25.3	1.2	40	188	11	7.3
STH-600-5.0	5.0	44	26.0	21.1	28.6	1.2	55	275	12	13.8
STH-600-5.0	5.0	57	22.9	18.0	26.0	1.2	40	200	11	6.9
STH-600-6.8	6.8	57	26.4	21.5	29.5	1.2	40	272	11	13.0
STH-600-10	10	57	31.7	25.1	36.3	1.2	40	400	12	9.7
STH-600-12	12	57	34.6	27.9	39.1	1.2	40	480	12	6.8
STH-600-15	15	57	38.5	31.8	43.0	1.2	40	600	12	5.8
<b>Ur 700Vdc, Upk 1000Vdc, Urms 400Vac</b>										
STH-700-0.22	0.22	32	10.5	6.4	12.8	0.8	105	23	3.5	56.2
STH-700-0.33	0.33	32	12.2	8.1	14.5	0.8	105	35	4.5	38.6
STH-700-0.47	0.47	32	14.1	10.0	16.4	0.8	105	49	6.5	27.7
STH-700-0.68	0.68	32	16.5	11.7	19.7	1.0	105	71	8	19.6
STH-700-1.0	1.0	32	19.6	14.7	22.7	1.0	105	105	9	13.6
STH-700-1.0	1.0	44	16.4	11.5	19.5	1.0	70	70	9	25.1
STH-700-1.2	1.2	32	21.3	16.4	24.4	1.0	105	126	9	11.5
STH-700-1.2	1.2	44	17.8	12.9	20.9	1.0	70	84	9	21.1
STH-700-1.5	1.5	44	19.6	14.7	22.7	1.0	70	105	9	17.1
STH-700-2.0	2.0	44	22.3	17.4	25.4	1.2	70	140	12	13.0
STH-700-2.2	2.2	44	23.3	18.4	26.4	1.2	70	154	12	11.9
STH-700-2.5	2.5	44	24.8	19.8	27.8	1.2	70	175	12	10.6
STH-700-3.0	3.0	44	26.9	20.4	31.6	1.2	70	210	12	8.9
STH-700-3.3	3.3	44	28.2	21.6	32.8	1.2	70	231	12	8.2
STH-700-4.0	4.0	44	30.8	24.3	35.5	1.2	70	280	12	6.9
STH-700-4.0	4.0	57	25.5	20.6	28.6	1.2	45	180	12	12.9
STH-700-4.7	4.7	57	27.5	21.0	32.2	1.2	45	212	12	11.1
STH-700-5.0	5.0	57	28.3	21.8	33.0	1.2	45	225	12	10.5
STH-700-6.8	6.8	57	32.7	26.1	37.3	1.2	45	306	12	7.9
STH-700-8.2	8.2	57	35.8	29.1	40.3	1.2	45	369	12	6.6
STH-700-10	10	57	39.4	32.6	43.8	1.2	45	450	12	5.6

## Electrical specifications, ordering codes

Part Number	Cap ( $\mu$ F)	Dimension (mm)					du/dt (v/ $\mu$ s)	Ipeak (A)	Irms max.(A)	ESR (m $\Omega$ )
		flat,oval								
		L	D	T	H	d				
<b>Ur 850Vdc, Upk 1200Vdc, Urms 450Vac</b>										
STH-850-0.15	0.15	32	10.5	6.4	12.8	0.8	200	30	4.5	66.9
STH-850-0.22	0.22	32	12.1	8.0	14.4	0.8	200	44	5.5	47.1
STH-850-0.33	0.33	32	14.3	10.2	16.6	0.8	200	66	7	32.3
STH-850-0.47	0.47	32	16.6	11.8	19.8	1.0	200	94	9	23.2
STH-850-0.68	0.68	32	19.5	14.6	22.6	1.0	200	136	9	16.4
STH-850-0.68	0.68	44	16.3	11.5	19.5	1.0	110	75	9	30.2
STH-850-1.0	1.0	32	23.2	18.3	26.3	1.2	200	200	12	11.5
STH-850-1.0	1.0	44	19.4	14.5	22.5	1.0	110	110	9	21.0
STH-850-1.5	1.5	44	23.2	18.3	26.3	1.2	110	165	12	14.3
STH-850-2.0	2.0	44	26.5	21.6	29.6	1.2	110	220	12	11.0
STH-850-2.2	2.2	44	27.7	21.2	32.4	1.2	110	242	12	10.0
STH-850-2.2	2.2	57	23.0	18.1	26.1	1.2	55	121	12	19.1
STH-850-2.5	2.5	44	29.5	22.9	34.1	1.2	110	275	12	8.9
STH-850-2.5	2.5	57	24.4	19.4	27.4	1.2	55	138	12	16.9
STH-850-3.0	3.0	44	32.1	25.5	36.7	1.2	110	330	12	7.5
STH-850-3.0	3.0	57	26.5	21.6	29.6	1.2	55	165	12	14.2
STH-850-3.3	3.3	57	27.7	21.2	32.4	1.2	55	182	12	13.0
STH-850-4.0	4.0	57	30.4	23.8	35.0	1.2	55	220	12	10.9
STH-850-4.7	4.7	57	32.8	26.1	37.3	1.2	55	259	12	9.3
STH-850-5.0	5.0	57	33.7	27.1	38.3	1.2	55	275	12	8.8
STH-850-6.8	6.8	57	39.1	32.4	43.6	1.2	55	374	12	6.7