

### GENERAL TECHNICAL CHARACTERISTICS

Reference standards : IEC 61071-60068  
 Dielectric : Polypropylene film  
 Construction : Dry construction, filled by solid resin  
 Case : Aluminium case



### ELECTRICAL CHARACTERISTICS

Working temperature : -40 to + 85 °C  
 Capacitance : 10 to 150µF  
 Rated Voltage : 400 to 850 Vdc (250 to 450Vac)  
 Tolerance : ± 5% , ± 10%  
 Life expectancy : 100,000 hours at Un and 70 °C  
 30,000 hours at Urms

### TEST METHODS AND PERFORMANCES

Test voltage between terminals : 1.5xUrms for 60s at 25 °C  
 Test voltage terminal to case : 3 KV 50Hz for 60sec

### DESIGN

Terminals styles : Brass screw terminals  
 Aluminium case with or without, Threaded bolt M10

Case	Brass screw terminals		Bolt
	Output	Drive torque (Nm)	Drive torque (Nm)
D ≤ 65 mm	M5	4	8

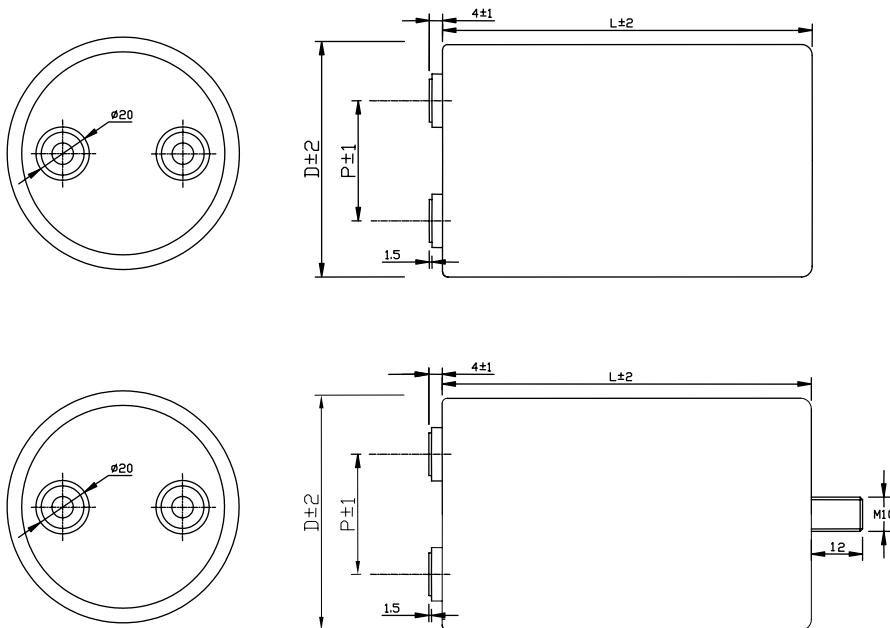

### How to order

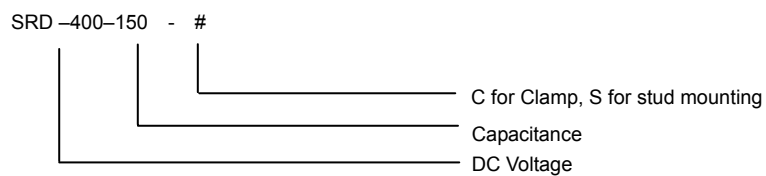

## Electrical specifications, ordering codes

Part Number	Capacitance ( $\mu$ F)	Diameter (mm)	Height (mm)	P (mm)	Du/dt (V/ $\mu$ s)	I <sub>rms</sub> max.	ESR (m $\Omega$ )
<b>Un dc 400V , Upk dc 600V ,Urms ac 250V</b>							
SRD-400-25	25	45	80	22	30	18	5.2
SRD-400-35	35	50	80	22	30	20	4.0
SRD-400-45	45	55	80	22	30	22	3.3
SRD-400-55	55	60	80	22	30	25	2.9
SRD-400-65	65	65	80	28.6	30	30	2.6
SRD-400-70	70	60	95	22	24	25	3.3
SRD-400-80	80	65	95	22	24	30	3.0
SRD-400-90	90	60	120	28.6	18	25	4.1
SRD-400-110	110	65	120	28.6	18	30	3.5
<b>Un dc 600V , Upk dc 800V ,Urms ac 330V</b>							
SRD-600-20	20	45	80	22	38	18	5.6
SRD-600-25	25	50	80	22	38	20	4.7
SRD-600-30	30	55	80	22	38	22	4.1
SRD-600-40	40	60	80	22	38	25	3.3
SRD-600-45	45	65	80	28.6	38	30	3.0
SRD-600-50	50	60	95	22	30	25	3.8
SRD-600-60	60	65	95	28.6	30	30	3.3
SRD-600-70	70	60	120	22	22	25	4.5
SRD-600-80	80	65	120	28.6	22	30	4.1
<b>Un dc 700V , Upk dc 900V ,Urms ac 400V</b>							
SRD-700-12.5	12.5	45	80	22	52	18	6.8
SRD-700-18	18	50	80	22	52	20	5.0
SRD-700-22	22	55	80	22	52	22	4.3
SRD-700-25	25	60	80	22	52	25	3.9
SRD-700-30	30	65	80	28.6	52	30	3.4
SRD-700-33	33	60	95	22	41	25	4.4
SRD-700-45	45	60	120	22	30	30	5.3
SRD-700-50	50	65	120	28.6	30	25	4.9
<b>Un dc 850V , Upk dc 1000V ,Urms ac 450V</b>							
SRD-850-10	10	50	80	22	68	18	7.1
SRD-850-12	12	50	80	22	68	20	6.1
SRD-850-15	15	55	80	22	68	22	5.0
SRD-850-18	18	60	80	22	68	25	4.4
SRD-850-20	20	65	80	28.6	68	30	4.0
SRD-850-22	22	60	95	22	53	25	5.2
SRD-850-25	25	65	95	28.6	53	30	4.7
SRD-850-30	30	60	120	22	39	25	6.4
SRD-850-35	35	65	120	28.6	39	30	5.6